

***SIMPLY LED***

09/2023

SIMPLY LED

**WOLFSGRUBER**  
innovative steel design

# La novità dell'illuminazione dei parapetti

Il corrimano con led SIMPLY LED rende l'illuminazione dei parapetti più elegante e sicura.

**Il grado d'illuminazione è fino al 50% superiore rispetto ai sistemi d'illuminazione con corrimano tradizionale.**

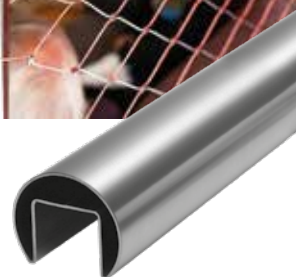

## Dati tecnici

- **Copertura ottica mediante rifrazione della luce** che permette di orientare il fascio luminoso nella direzione desiderata;
- **50.000 ore di utilizzo** garantite;
- **Luce bianca calda** 3.000 Kelvin;
- I supporti dei corrimani, modificati per il passaggio dei cavi, sono **identici** ai supporti standard, in modo da garantire perfetta **uniformità** tra corrimano led e corrimani normali;
- **Compatibile** per i seguenti corrimano scanalati: tubo 42,4 – tubo 40x40 – tubo 60x40 – tubo ovale;
- **Semplice** installazione;
- Prezzo molto competitivo.

Il file EULUMDAT può essere scaricato dal nostro sito web ( L1010220.LDT).

**Attenzione:** non compatibile con parapetti in vetro.

### ESCLUSIONE DI RESPONSABILITÀ

Tutte le indicazioni vengono fornite con l'intenzione di correttezza e completezza. Wolfgruber è grato per qualsiasi segnalazione di errori o dati mancanti. Tutti i dati contenuti in questo catalogo sono validi al momento della stampa. Ci riserviamo il diritto di modifiche ai fini di un continuo miglioramento tecnico o correzione di errori.

### COPYRIGHT

Il presente catalogo è proprietà intellettuale della Wolfgruber Srl. La Wolfgruber Srl si riserva espressamente il diritto di proprietà e di autore delle informazioni contenute nel catalogo. La ristampa e la riproduzione, anche parziali, sono consentite solo previa autorizzazione scritta della Wolfgruber Srl. Con riserva di modifiche tecniche e salvo errori di stampa. Tutti i prezzi si intendono Iva esclusa. Solo fino ad esaurimento scorte.



SIMPLY LED BASIC

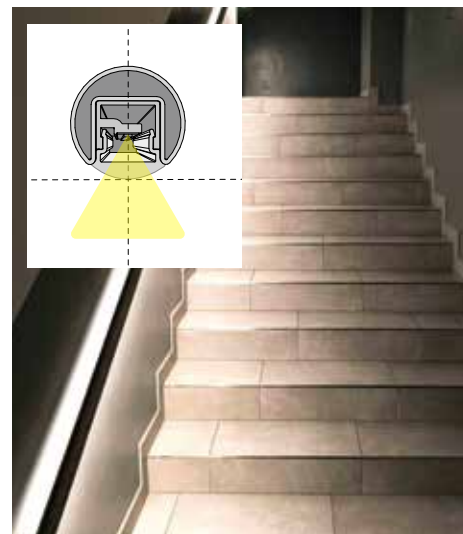
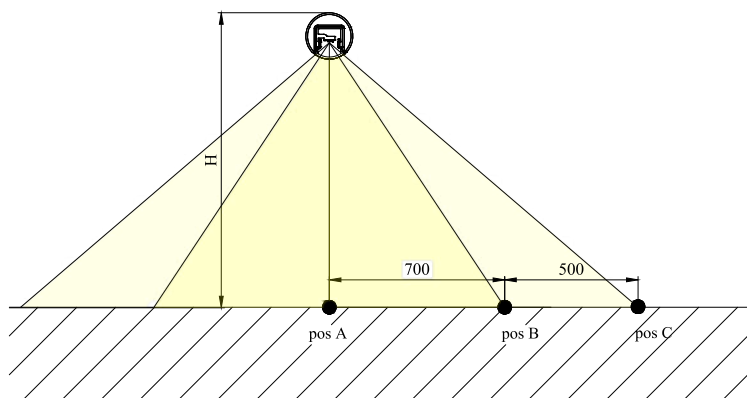

	H POS	900 mm			1000 mm			1100 mm			1200 mm		
		A	B	C	A	B	C	A	B	C	A	B	C
<b>L1020160</b>	4,8 w/ml	156 lx	92 lx	38 lx	133 lx	86 lx	39 lx	117 lx	79 lx	39 lx	106 lx	71 lx	39 lx
<b>L1020260</b>	9,6 w/ml	287 lx	168 lx	71 lx	249 lx	165 lx	71 lx	220 lx	150 lx	72 lx	196 lx	140 lx	72 lx
<b>L1020360</b>	12,6 w/ml	484 lx	270 lx	120 lx	418 lx	250 lx	122 lx	370 lx	242 lx	122 lx	332 lx	224 lx	122 lx
striscia LED	watt/ml	Luminosità (lx) a varie altezze e posizioni / Colore luce: bianco caldo 3000K I valori rilevati sono da ritenere indicativi; variazioni possibili in base al luogo d'installazione											

SIMPLY LED DIRECTED

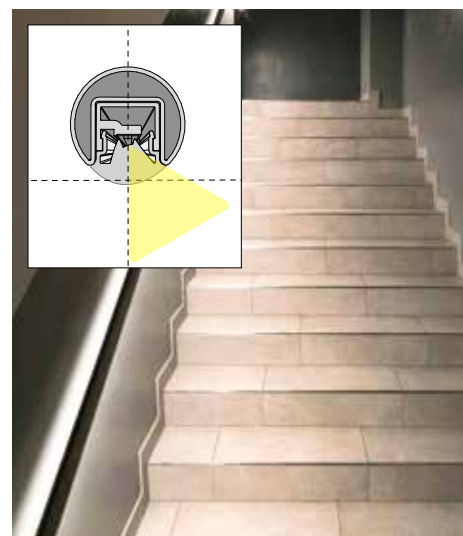
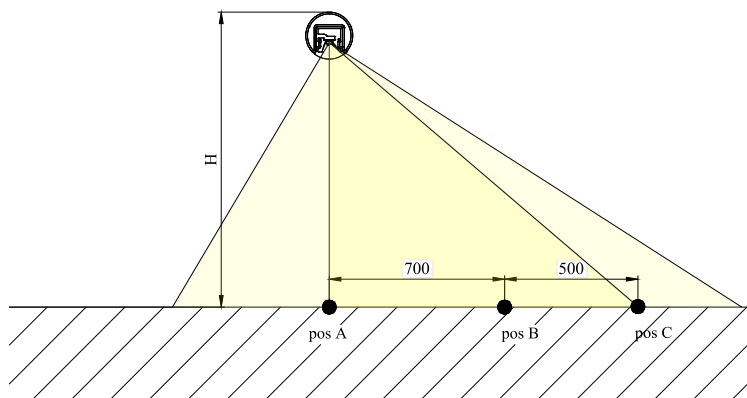

	H POS	900 mm			1000 mm			1100 mm			1200 mm		
		A	B	C	A	B	C	A	B	C	A	B	C
<b>L1020160</b>	4,8 w/ml	156 lx	135 lx	50 lx	133 lx	125 lx	52 lx	117 lx	115 lx	53 lx	106 lx	106 lx	53 lx
<b>L1020260</b>	9,6 w/ml	287 lx	256 lx	111 lx	249 lx	240 lx	115 lx	220 lx	223 lx	116 lx	196 lx	207 lx	118 lx
<b>L1020360</b>	12,6 w/ml	484 lx	397 lx	180 lx	418 lx	370 lx	185 lx	370 lx	350 lx	187 lx	332 lx	321 lx	187 lx
striscia LED	watt/ml	Luminosità (lx) a varie altezze e posizioni / Colore luce: bianco caldo 3000K I valori rilevati sono da ritenere indicativi; variazioni possibili in base al luogo d'installazione											

Valori caratteristici della luce:

luce diretta del sole = 100.000lx - luce del sole in caso di nuvole = 10.000lx - illuminazione da salone = 100lx - illuminazione stradale = 10 lx - illuminazione candela 1m distanza = 1lx

tubo scanalato

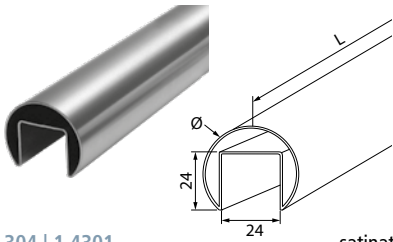

304 | 1.4301 satinato

ART.	Ø	L
67702	42,4x1,5	3000
67703	42,4x1,5	6000

316 | 1.4401 satinato

ART.	Ø	L
67702-V4A	42,4x1,5	3000
67703-V4A	42,4x1,5	6000

316 | 1.4401 lucidato

ART.	Ø	L
67702-V4A-P	42,4x1,5	3000
67703-V4A-P	42,4x1,5	6000

profilo supporto LED  
(info 2)

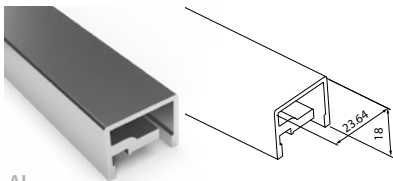

AL

ART.	L
L1010010	3000

tubo scanalato

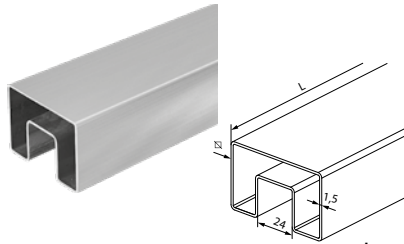

304 | 1.4301 satinato

ART.	Ø	L
67708	40x40 x1,5	3000
67709	40x40 x1,5	6000
67710	60x40 x1,5	3000
67711	60x40 x1,5	6000

316 | 1.4401 satinato

ART.	Ø	L
67708-V4A	40x40 x1,5	3000
67709-V4A	40x40 x1,5	6000
67710-V4A	60x40 x1,5	3000
67711-V4A	60x40 x1,5	6000

raccordo per supporto corrimano  
(info 1)

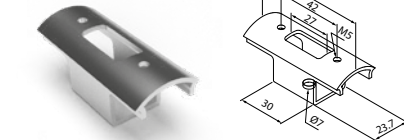

316 | 1.4401 satinato

ART.	L	AxB
L1040050	5000	12x1

316 | 1.4401 lucidato

ART.	L	AxB
L1040051	5000	12x1

tubo scanalato

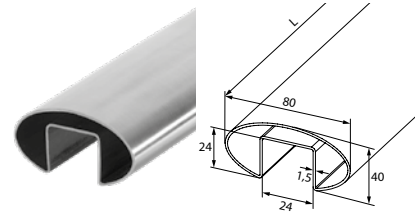

316 | 1.4401 satinato

ART.	Ø	L
67713-V4A	80x40 x1,5	3000
67714-V4A	80x40 x1,5	6000

striscia biadesiva  
(info 2)

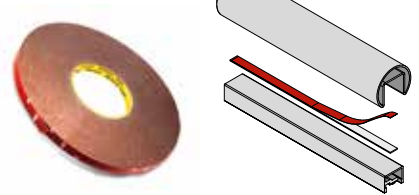

ART.	L	AxB
L1040100	5000	12x1

cavo di prolunga



ART.	CAVO
L1041360	2x0,5mm <sup>2</sup>

## Istruzione di montaggio

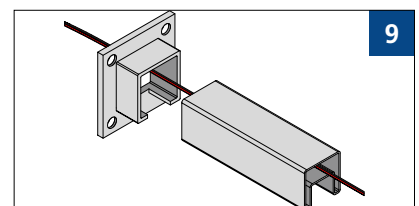
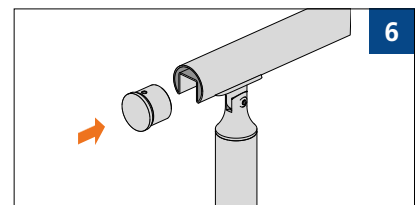
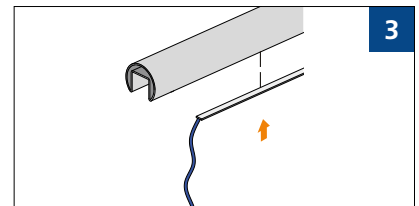
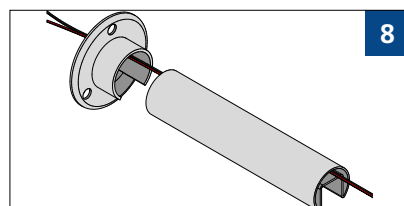
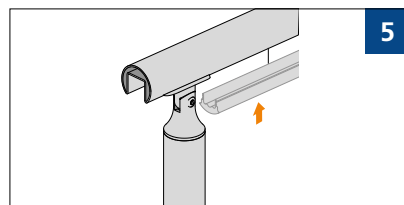
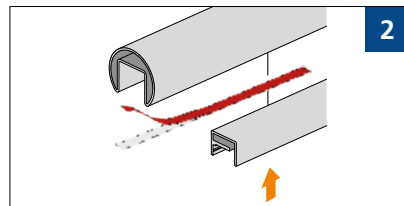
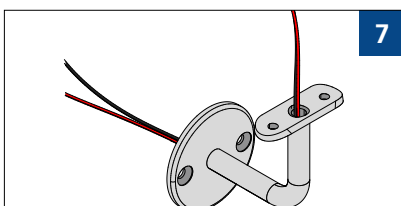
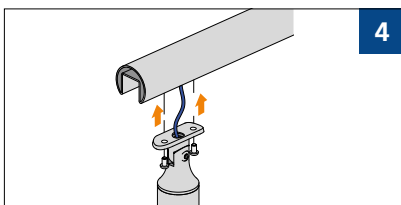
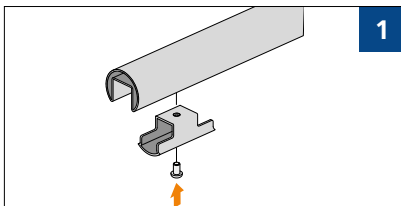

## profilo trasparente copertura BASIC (info 5)

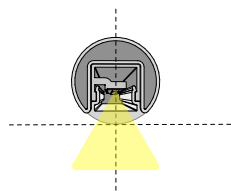

plastica

ART.	L
<b>L1010120</b>	3000

## profilo trasparente copertura DIRECTED (info 5)

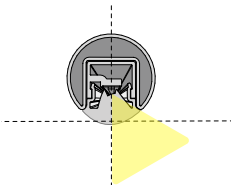
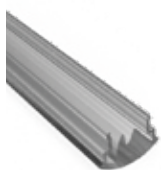

plastica

ART.	L
<b>L1010220</b>	3000

## supporto corrimano LED (info 4)

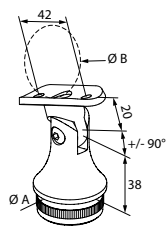
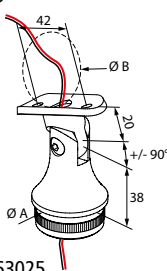

304 | 1.4301 L-63025 63025 satinato

ART.	Ø A	Ø B
<b>L-63025</b>	42,4x2	42,4
<b>63025</b>	42,4x2	42,4

316 | 1.4401 satinato

ART.	Ø A	Ø B
<b>L-63025-V4A</b>	42,4x2	42,4
<b>63025-V4A</b>	42,4x2	42,4

316 | 1.4401 lucidato

ART.	Ø A	Ø B
<b>L-63025-V4A-P</b>	42,4x2	42,4
<b>63025-V4A-P</b>	42,4x2	42,4

## striscia LED (info 3)



colore luce 3000K



ART.	WATT/METRO	LUMEN
<b>L1020160</b>	4,8	430
<b>L1020260</b>	9,6	860
<b>L1020360</b>	12,6	1400

## supporto corrimano LED da parete (info 7)

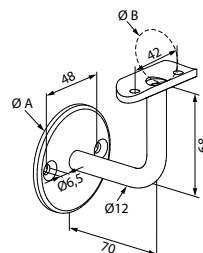
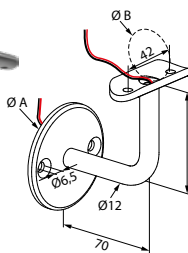

304 | 1.4301 L-66065 66065 satinato

ART.	Ø A	Ø B
<b>L-66065</b>	68x5,0	42,4
<b>66065</b>	68x5,0	42,4

316 | 1.4401 satinato

ART.	Ø A	Ø B
<b>L-66065-V4A</b>	68x5,0	42,4
<b>66065-V4A</b>	68x5,0	42,4

316 | 1.4401 lucidato

ART.	Ø A	Ø B
<b>L-66065-V4A-P</b>	68x5,0	42,4
<b>66065-V4A-P</b>	68x5,0	42,4

## supporto corrimano LED (info 4)

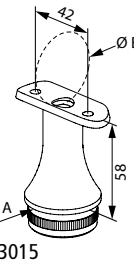
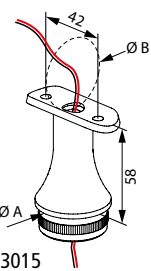

304 | 1.4301 L-63015 63015 satinato

ART.	Ø A	Ø B
<b>L-63015</b>	42,4x2	42,4
<b>63015</b>	42,4x2	42,4

316 | 1.4401 satinato

ART.	Ø A	Ø B
<b>L-63015-V4A</b>	42,4x2	42,4
<b>63015-V4A</b>	42,4x2	42,4

316 | 1.4401 lucidato

ART.	Ø A	Ø B
<b>L-63015-V4A-P</b>	42,4x2	42,4
<b>63015-V4A-P</b>	42,4x2	42,4

## cavo di alimentazione LED

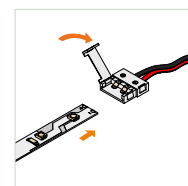

ART.	CAVO	L
<b>L1041160</b>	2x0,5	2500

# SIMPLY LED

## connettore



ART.	CAVO
<b>L1042160</b>	2x0,4-0,7
<b>L1042260</b>	3x0,4-0,7

## connettore IP 67

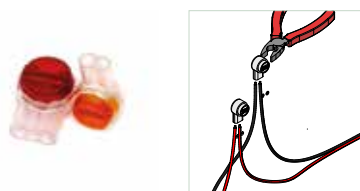

ART.	CAVO
<b>L1042360</b>	2x0,4-0,7
<b>L1042460</b>	3x0,4-0,7

## alimentatore

(vedi esempio di calcolo sotto)



ART.	VOLT	WATT	DIM
<b>L1030160</b>	24	20	120 x 365 x 27
<b>L1030260</b>	24	35	150 x 40 x 30
<b>L1030360</b>	24	60	164 x 42 x 32
<b>L1030460</b>	24	100	180 x 53 x 37
<b>L1030560</b>	24	150	107 x 64 x 38

## sigillo protettivo

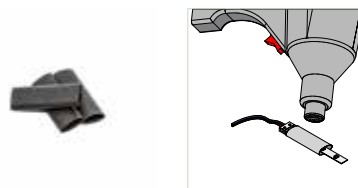

ART.	Ø	L
<b>L1042560</b>	11	50

## connettore LED



ART.	CAVO	L
<b>L1041260</b>	2x0,5	150

## rivettatrice per inserti filettati



ART.
<b>69310</b>

## vite con testa bombata



304   1.4301		
ART.	FILETTO	L
<b>63144</b>	M6   dx	12

## inserto filettato

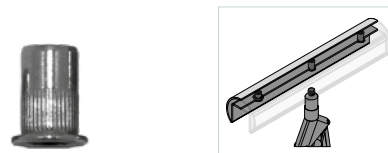

304   1.4301		
ART.	Ø	FOR.
<b>L1040140</b>	M6	Ø9

## Esempio di calcolo

### striscia LED

ART.	
<b>L1020160</b>	4,8 watt/ml
<b>L1020260</b>	9,6 watt/ml
<b>L1020360</b>	12,6 watt/ml

### alimentatore

ART. L1030160	ART. L1030260	ART. L1030360	ART. L1030460	ART. L1030560
20 WATT	35 WATT	60 WATT	100 WATT	150 WATT
4,2 ml	7,3 ml	12,5 ml	20,8 ml	31,3 ml
2,1 ml	3,6 ml	6,3 ml	10,4 ml	15,6 ml
1,6 ml	2,8 ml	4,8 ml	7,9 ml	11,9 ml

raccordo per tubo  
(info 8)

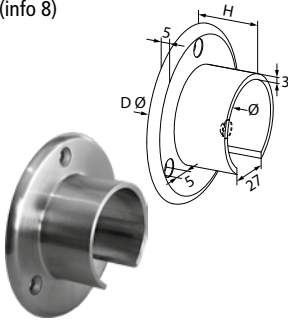

316   1.4401	satinato		
ART.	Ø	Ø D	H
<b>67762</b>	42,4	90	30

316   1.4401	lucidato		
ART.	Ø	Ø D	H
<b>67762-V4A-P</b>	42,4	90	30

raccordo per tubo

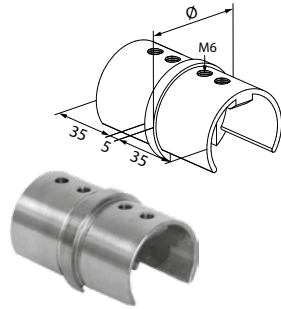

316   1.4401	satinato		
ART.	Ø		
<b>67732</b>	42,4		

316   1.4401	lucidato		
ART.	Ø		
<b>67732-V4A-P</b>	42,4		

raccordo per tubo

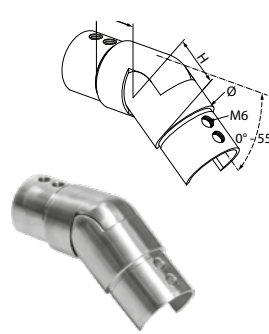

316   1.4401	satinato		
ART.	Ø	H	
<b>67782</b>	42,4	30	

316   1.4401	lucidato		
ART.	Ø	H	
<b>67782-V4A-P</b>	42,4	30	

raccordo per tubo

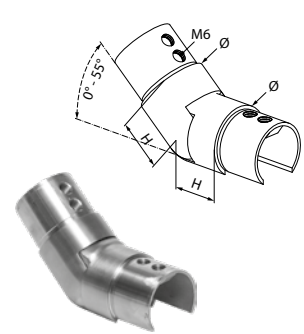

316   1.4401	satinato		
ART.	Ø	H	
<b>67784</b>	42,4	30	

316   1.4401	lucidato		
ART.	Ø	H	
<b>67784-V4A-P</b>	42,4	30	

raccordo per tubo 90° orizzontale

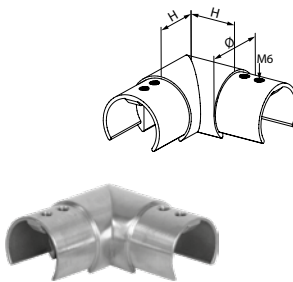

316   1.4401	satinato		
ART.	Ø	H	
<b>67712</b>	42,4	30	

316   1.4401	lucidato		
ART.	Ø	H	
<b>67712-V4A-P</b>	42,4	30	

tappo di copertura  
(info 6)

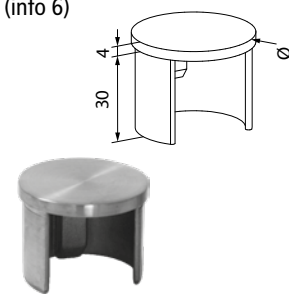

316   1.4401	satinato		
ART.	Ø		
<b>67742</b>	42,4		

316   1.4401	lucidato		
ART.	Ø		
<b>67742-V4A-P</b>	42,4		

tappo di copertura

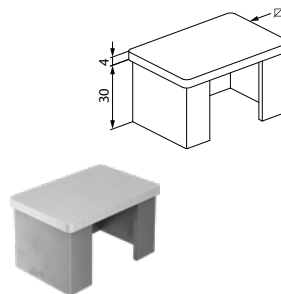

316   1.4401	satinato		
ART.	Ø		
<b>67747</b>	40x40 x1,5		
<b>67748</b>	60x40 x1,5		

raccordo per tubo  
(info 9)

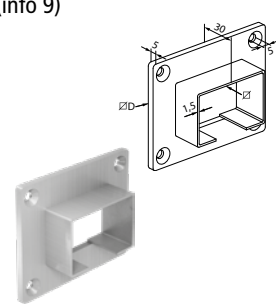

316   1.4401	satinato		
ART.	Ø	DIM.	
<b>67767</b>	40x40 x1,5	80x80	
<b>67768</b>	60x40 x1,5	100x80	

316   1.4401	lucidato		
ART.	Ø	DIM.	
<b>67767</b>	40x40 x1,5	80x80	
<b>67768</b>	60x40 x1,5	100x80	

raccordo per tubo

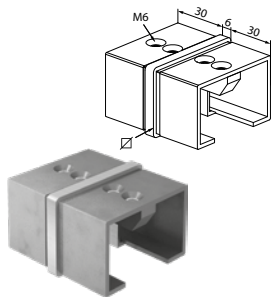

316   1.4401	satinato		
ART.	Ø		
<b>67737</b>	40x40 x1,5		
<b>67738</b>	60x40 x1,5		

raccordo 90° orizzontale

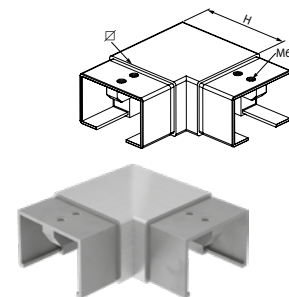

316   1.4401	satinato		
ART.	Ø	H	
<b>67717</b>	40x40 x1,5	60	
<b>67718</b>	60x40 x1,5	70	

raccordo per tubo

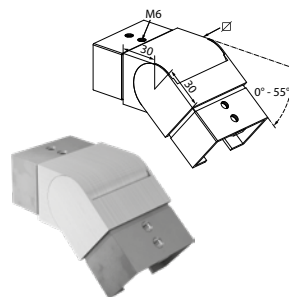

316   1.4401	satinato		
ART.	Ø		
<b>67786</b>	40x40 x1,5		
<b>67787</b>	60x40 x1,5		

raccordo per tubo

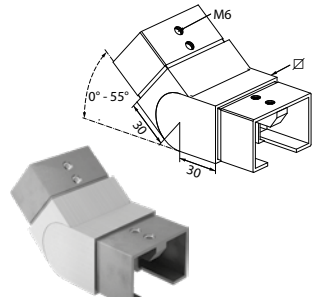

316   1.4401	satinato		
ART.	Ø		
<b>67788</b>	40x40 x1,5		
<b>67789</b>	60x40 x1,5		



**WOLFSGRUBER srl**

via campi della Rienza 15

I-39031 Brunico (BZ)

T +39 0474 55 22 31

info@wolfsgruber.it

**[www.wolfsgruber.it](http://www.wolfsgruber.it)**